

A WALL-SUSPENDED MODEL, 3 DOORS, 3 MODES OF OPERATION



Thermal comfort

- > 3 operating modes:
 - glass door position**: excellent efficiency and safety
 - open-fire position**: Enjoy the flames, grilling and the smell of the wood fire,..
 - door fully closed position**: to let the fire smoulder during a short absence or to hide the combustion chamber when the stove is not in use.
- > you can switch from one operation mode to another in seconds
- > the duct, which is an integral part of the stove, contributes to diffusing heat in the room by means of convection.

Performances, respect for the environment

- > excellent efficiency (82,7%)
- > the combustion chamber is smaller (lower output) and can be adapted to heat smaller spaces or energy-efficient homes.
- > state-of-the-art post-combustion system
- > tax benefits (according to country or area)
- > low CO emissions (< 0.09% CO whereas the limit for emissions in Belgium is below 1%)

Aspect

- > subtle overhead design
- > less space required, space freed up on the floor
- > door fully closed conceals hearth when not in use

photo by Jean-Luc Laloux

Ergonomics, usage

- > burns 33 cm logs (horizontally)
- > anti-dirt mechanism for the glass door ensuring high performance even during low operation
- > no back-draught in open fire mode
- > single control automatically regulates combustion air, post-combustion air and air for sweeping the glass door
- > Stûv compatible barbecue kit!

Installation & maintenance

- > simple and quick installation
- > no decoration work required
- > a Ø 180 mm flue will do
- > connection to the chimney above or behind
- > option of drawing the fresh air required for combustion from outside the building (without using room air). The stove is housed in the bottom of a cover which connects it to the ground



Dimensions & technical data

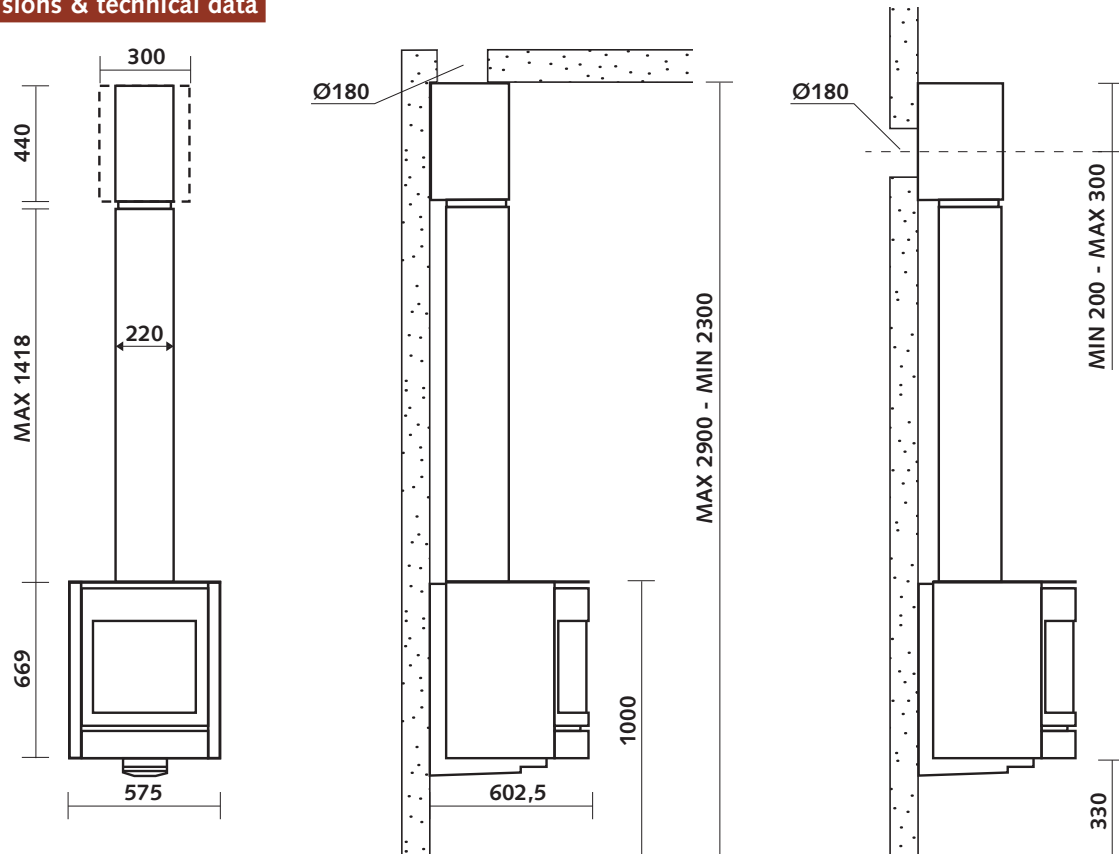

conforms to the standard EN 16510 - ECODESIGN 2022  patent nr 1130323.

unit mass: 151 kg

optimal range of use: 4,1 - 12,1 kW

rated power efficiency: 8,3 kW

efficiency measured at rated power: 82,7%^(a)

CO emissions: 0,05 % / 564 mg/Nm^{3(a)}

particle emissions: 38 mg/Nm^{3 (b)}

range of wood consumption / hour at 12% humidity (as an indication): 1,2 - 3,5 kg/h

length of the wood logs: 33 cm (horizontally)

minimum safety distance between the combustible materials and the sides of the stove: 10 cm

minimum draught needed to reach calorific rated power: 12 Pa^(a)

weight-flow ratio of smokes: 8,4 g/s^(a)

mean smoke temperature at rated power: 118°C^(a)

energy efficiency index (EEI): 110

energy efficiency class: A+

(a) In the "glass door" position

(b) measurement method based on DIN+

Easy to install

The hot air outlet is integrated. The stove is easily connected to the chimney flue; no finishing or decoration work is required.

The stove has to be installed on a non-combustible wall of sufficient strength above a non-combustible floor.

Fresh air

The air required for combustion can be drawn from outside the building.

Smoke exits

From the rear or from the top, Ø180 mm. The standard flue supplied with the stove can be used with ceiling heights up to 2.9 metres.

Measuring the size of the chimney flue

The Stûv 30-up will only operate adequately if the draught value of the chimney flue T is between **2000** and **4000**.

Measuring the draught: $T = \frac{S \times \sqrt{H}}{G}$

T is the chimney draught

S is the flue cross-section (in cm²)

H is the height of chimney (in m),
measured from the base of the flames

G characterises the geometry of the chimney; it is given in the table below.

This figures have been calculated for masonry conducts. For a pre-built steel conduct, you can increase the T figure with 20%.

The accessories



Barbecue kit

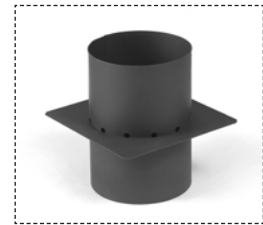

Flue union



Open fire valve



Bottom cover



Outside air valve

Table of G coefficients

	a	b	c	d	e	f
	Straight flue with or without rotating cap	Straight flue with fixed cap	30° offset with or without rotating cap	30° offset with fixed cap	45° offset with or without rotating cap	45° offset with fixed cap
Insulated interior flue	0.19	0.29	0.31	0.41	0.37	0.47
Insulated exterior flue	0.25	0.35	0.37	0.47	0.43	0.53
Non-insulated interior flue	0.30	0.40	0.42	0.52	0.48	0.58

Concept & Forme reserve the right to alter Stûv stoves without prior notice. Information on www.stuv.eu is regularly updated.